

CASE STUDY

Beverage Filling Factory
Terra Production, Serbia

2020

Conveyor line for the ALU cans convey using Movex PFX Dry Running Belt

Project task: designing, producing and installing of „Dry Running PFX“ CS* - Conveyor System

Terra Production is a beverage filling service factory.

Terra purchased first Trasing Conveyor System for their lines 11 years ago and this project is the start of replacing old conveyors with new ones.

Both Companies wanted not just simply to replace but also to improve CS in every possible sense.

Programski arhiv: Kvalifikacija za projektiranje Tehničke škole za inženjere / Inženjerski biro u Zagrebu, arhiv. Originalni listovi su na raspolaganju u svim drugim jezicima.

Terra Production / D
Indija

The drawing will remain the sole property of company Trasing d.o.o. applicable only to the use of such drawing for the agreed purposes. Copies or other reproductions of any kind will not be made for any other than agreed purposes. Further requests for reproduction will be forwarded for consideration to any third parties.



Godina: 25. 12. 2018.

Projekt: **Transportni sistem**

Skala: 1:100

Projekat: P-6149-00

Stranica: 02

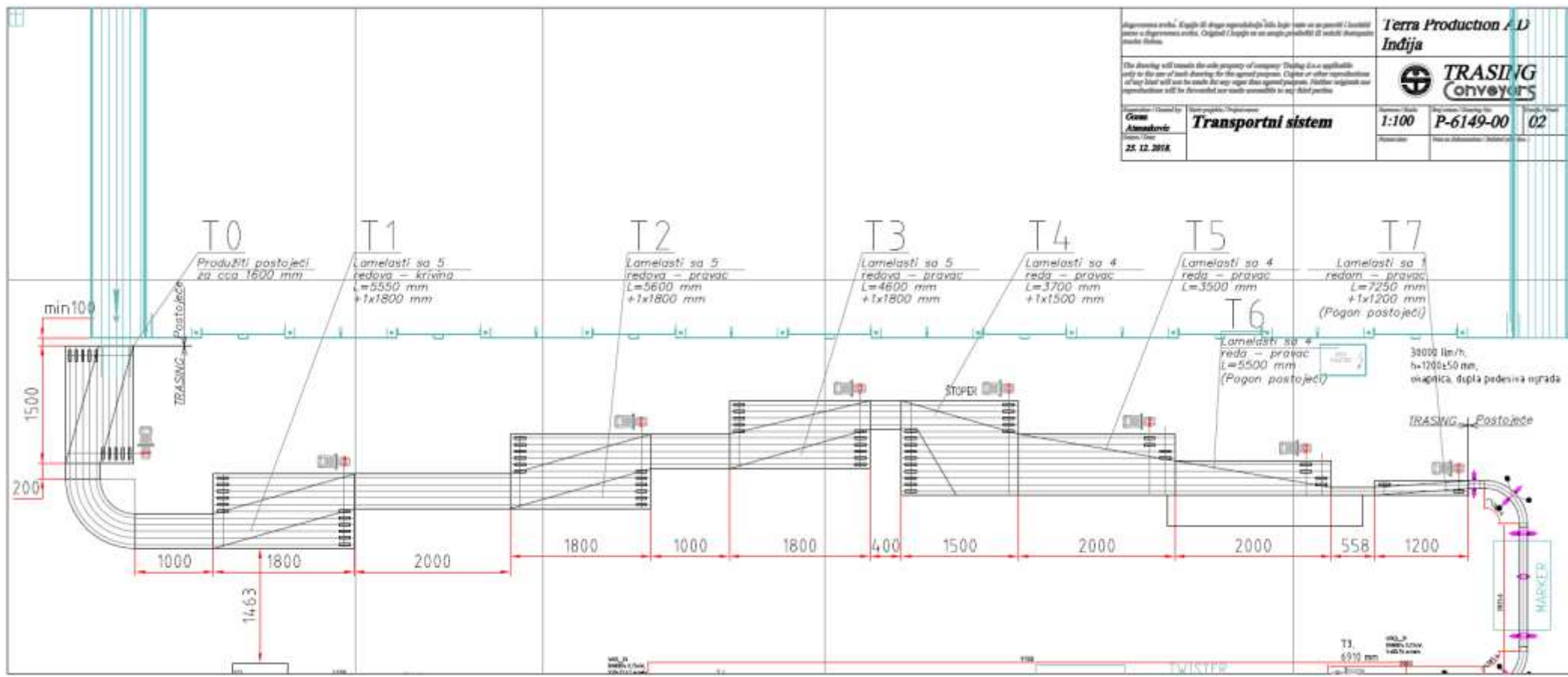

Lay Out of the System can be seen on the previous page

IT GOES FROM THE PASTEURIZER AND IS DESIGNED FOR THE MAX CAPACITY OF 40.000 PCS OF ALU CANS OF 0,5L PER HOUR.

INVESTOR ACCEPTED OUR SUGGESTION TO GO WITH DRY RUNNING SYSTEM, IN SENSE TO CUT EXPENSES ON LUBRICATIONS, AND MAN-HOUR OVERALL, NOT TO MENTION A CLEAR ENVIRONMENT AND BY MEASURING MUCH QUIETER SYSTEM.

TRASING DECIDE TO USE PFX OF MOVEX SPA, AS ALL OTHER COMPONENTS FROM THIS INTRALOGISTICS SUPPLIER.

CONNECTIONS BETWEEN TRASING AND MOVEX JUST MAKE IT ALL EASIER.

Implementation and integration was an easy one. PFX Belt is of perfect quality and therefore suitable for the high beverage line demands.





The first testing was on 20.000pcs/hour

Our technicians used that speed for the main adjustments. All of 10 conveyors with PFX Dry Running Belt were driven from the control spot.



Slightly, the speed was increased to 38.000pcs/hour



The line is working perfectly, 20hrs/day with improved cost management



Trasing will extensively use this example as a little revolution in beverage production material handling



FOR MORE INFORMATION, DO NOT HESITATE TO CONTACT US!



CONTACT

YOU CAN ALWAYS CONTACT US VIA PHONE OR E-MAIL

Trasing d.o.o.

Vojvode Putnika 1, 37212, Serbia

Email addresses:

Info: info@trasing.co.rs

Spare parts: spare.parts@trasing.co.rs

Technical support: customer.service@trasing.co.rs

Petar Gligorijević (direct contact)

Email: petar@trasing.co.rs

Phone: +381 37 806 590

Cell phone: +381 69 16 22 155

(Fax): +381 806 056